



Durham Close, Bury St. Edmunds, IP32 6TH

Rent - £1,100 PCM Deposit - £1,269

We delighted to offer this two bedroom mid-terraced house situated on the north side of town. The property consists of lounge, modern kitchen, 2 bedrooms and family bathroom. Externally there is a front and rear garden and off-road parking available. The property is offered unfurnished and is available now.

- MID TERRACED HOUSE
- 2 BEDROOMS
- MODERN KITCHEN
- FAMILY BATHROOM
- EARLY VIEWING ADVISED
- CLOSE TO TOWN CENTRE
- GAS HEATING & ENERGY RATING - C
- APPROXIMATE SIZE - 516 SQFT
- COUNCIL TAX BAND- C
- AVAILABLE NOW



Council Tax Band: B - EPC Rating: C 73

GROUND FLOOR

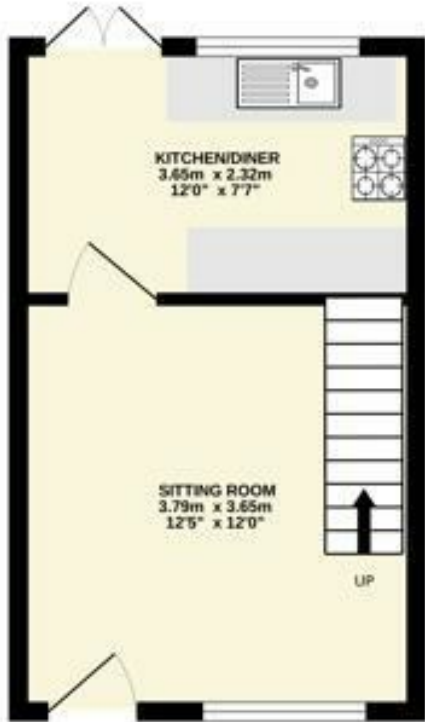

1ST FLOOR

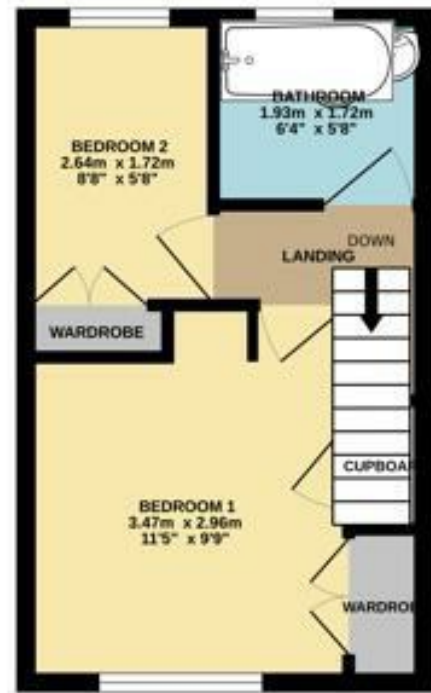

Whilst every attempt has been made to ensure the accuracy of the floorplan contained here, measurements of floors, windows, rooms and any other items are approximate and no responsibility is taken for any error, omission or mis-statement. This plan is for illustrative purposes only and should be used as such by any prospective purchaser. The services, systems and appliances shown have not been tested and no guarantee as to their operability or efficiency can be given.
Made with Heliograf 6/2020

